



NOTICE OF ADDENDUM

Date: 5/27/2025

RE: HAUL RD IMPROVEMENTS

The publication lacked engineered plans. Attached to this addendum is the plan set.

It is the responsibility of all BIDDERS to examine the entire BID DOCUMENTS package and seek clarification of any requirement that may not be clear and to check all responses for accuracy before submitting a BID.

This addendum and attached documents are required to be initialed and submitted as part of the bid documents. The Bid Form and this addendum, and associated attachments, shall be submitted with an original ink signature by the person authorized to sign the BID.

Change to bid submittal date, 6/18/2025

Sealed bids, including all addendums will be received by the City Clerk for the City of Page, Page City Hall, 697 Vista Avenue, Page, Arizona, until **4:30 PM, June 18, 2025**.

Kyle Christiansen
Director of Public Works
City of Page

4 CONSTRUCTION PLANS

4-1	Plan set, five pages.....	40
-----	---------------------------	----

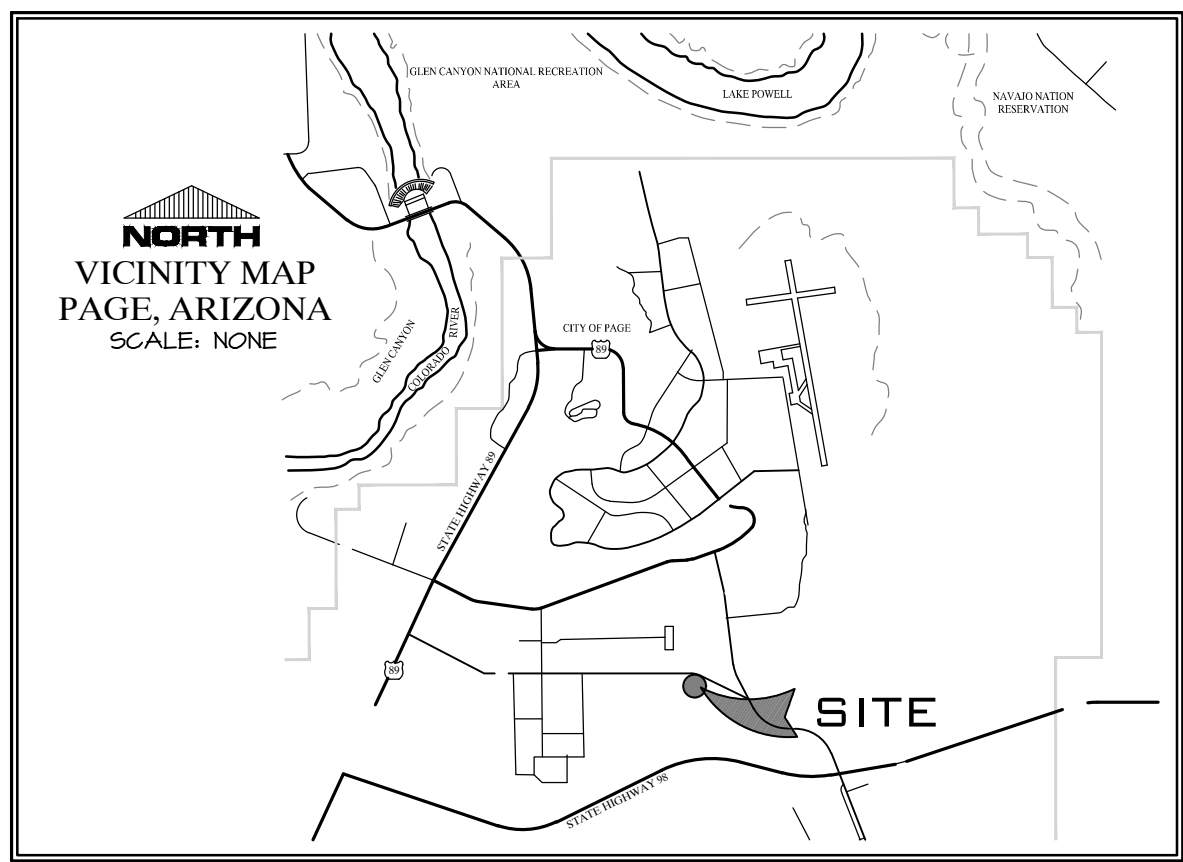

HAUL ROAD SOUTH IMPROVEMENTS

LOCATED IN SECTION 5, TOWNSHIP 40 NORTH, RANGE 9 EAST, G & SRM
PAGE, ARIZONA

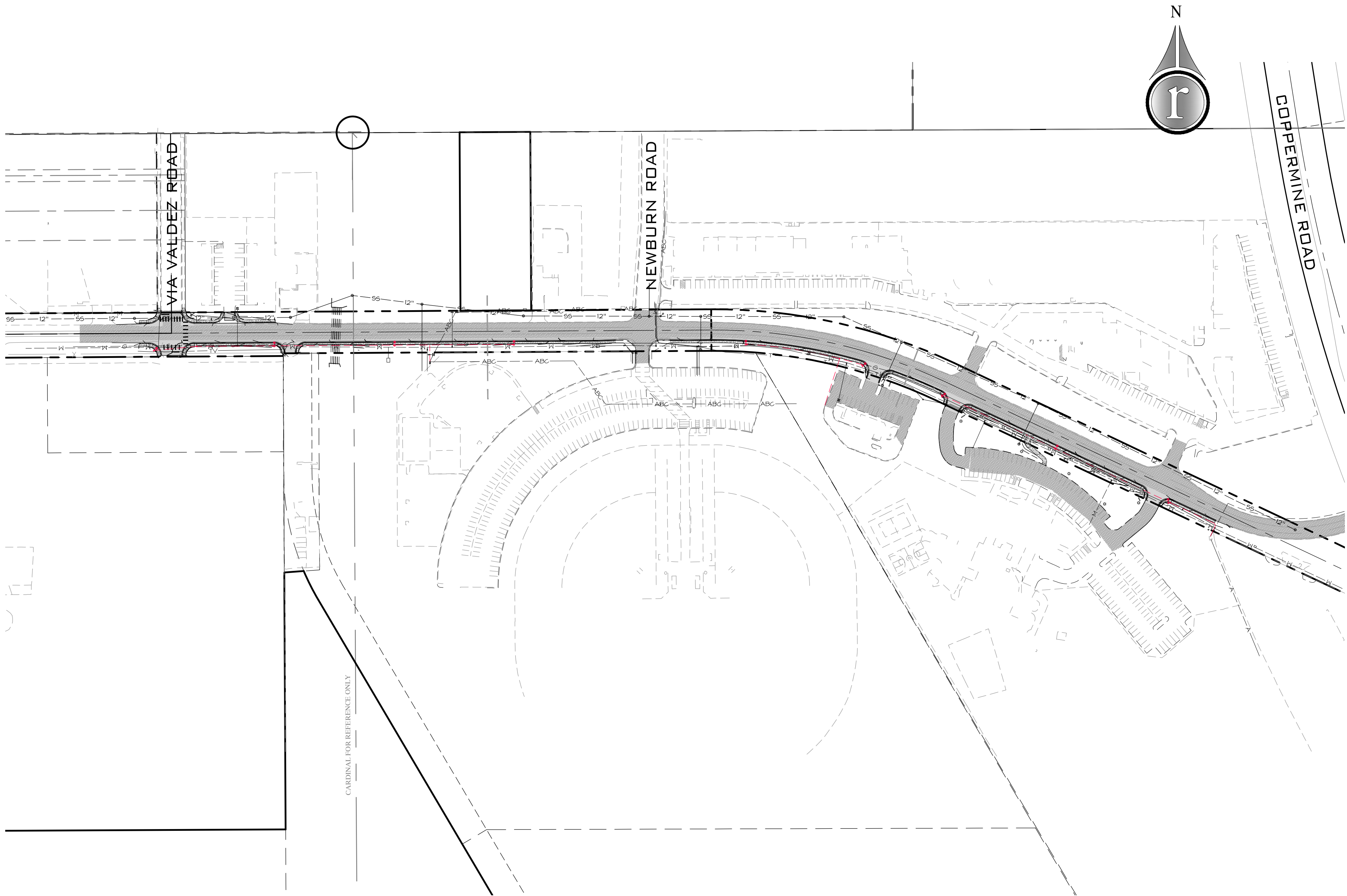

POWER

PAGE UTILITY ENTERPRISE
640 HAIL ROAD
PAGE, ARIZONA 86040
(928) 645-2419

WATER/SEWER

PAGE UTILITY ENTERPRISE
640 HAIL ROAD
PAGE, ARIZONA 86040
(928) 645-2419

PROPANE

ALLIANT GAS, LLC
2000 EAST FRONTAGE ROAD
PAGE, ARIZONA 86040
(928) 645-2341

CATV SERVICE

SOUTH CENTRAL COMMUNICATIONS
155 5TH AVENUE
PAGE, ARIZONA 86040
(928) 660-0512
CONTACT: GARRETT EDWARDS

TELEPHONE

QWEST COMMUNICATIONS
PAGE, ARIZONA 86040
(928) 714-4440

OWNER/DEVELOPER

THE OWNER FOR THIS PROJECT IS
CITY OF PAGE
641 VISTA AVENUE
PAGE, ARIZONA
CONTACT: KYLE CHRISTENSEN

PROJECT LOCATION

THE PROJECT IS LOCATED AT:
HAIL ROAD
VIA VALDEZ TO COPPERMINE
PAGE, ARIZONA

PROJECT ENGINEER

THE ENGINEER FOR THIS PROJECT IS:
ROSENBERG ASSOCIATES
MICHAEL S. ROBINSON
352 EAST RIVERSIDE DRIVE, SUITE A2
ST. GEORGE, UTAH 84790 (435) 673-8397

ENGINEER'S ACKNOWLEDGMENT:

I, Michael S. Robinson, Santa Clara, Utah do hereby certify that I am a Registered Professional Engineer as prescribed by the laws of the State of Arizona and that I hold Certificate of Registration (License) Number 44894. I further certify that the design of this site plan was made under my direction and supervision and is accurately represented on these plans.

Date: 02/19/2025

[Signature]
Michael S. Robinson

Certificate No. 44894

SHEET LAYOUT

SHEET NUMBER	SHEET DESCRIPTION
C1.0	COVER SHEET
C2.0	DEMOLITION PLAN
C3.0	SITE AND GRADING PLAN
C3.1	SITE AND GRADING PLAN
C3.2	SITE AND GRADING PLAN



Know what's below.
Call before you dig.

NOTICE: EXISTING UTILITIES ARE SHOWN ON PLANS FOR THE CONVENIENCE OF THE CONTRACTOR ONLY. THE CONTRACTOR IS RESPONSIBLE FOR THE LOCATION AND PROTECTION OF ALL UTILITIES. THE ENGINEER BEARS NO RESPONSIBILITY FOR UTILITIES NOT SHOWN OR SHOWN INCORRECTLY.

DATE:	02/19/2025
JOB NO.:	12448-24-006
DESIGNED BY:	FMD
CHECKED BY:	MSR
DWG:	CONST DOCS
DATE:	
REVISIONS:	

ROSENBERG
ASSOCIATES
CIVIL ENGINEERS • LAND SURVEYORS

352 East Riverside Drive, Suite A-2
St. George, Utah 84790
Ph (435) 673-8396, Fx (435) 673-8397
www.racivil.com

COVER SHEET
FOR
HAUL ROAD SOUTH IMPROVEMENTS
PAGE, ARIZONA

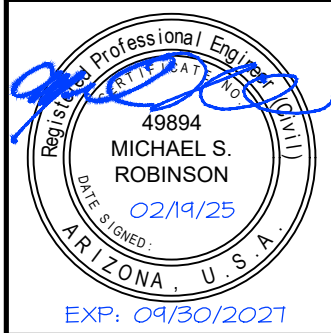

SHEET
C1.0
1 OF 5 SHEETS

GENERAL NOTES:

1. THE CONTRACTOR IS REQUIRED TO CALL THE CITY FOR INSPECTION OF ALL IMPROVEMENTS RELATED TO THIS PROJECT.
2. THE CONTRACTOR IS REQUIRED TO OBTAIN AN ENCROACHMENT PERMIT FOR ANY WORK PERFORMED IN A PUBLIC RIGHT-OF-WAY.
3. ANY NECESSARY MODIFICATIONS SHALL BE APPROVED BY THE DESIGN ENGINEER AND CITY PRIOR TO CONSTRUCTION.
4. ALL WORK SHALL BE CONTAINED ON THE SUBJECT SITE ONLY. NO STOCKPILING OR CONSTRUCTION ACTIVITY SHALL OCCUR OFF OF THE APPROVED LOT AREA, WITHOUT PRIOR WRITTEN CONSENT.
5. THE CONTRACTOR SHALL PROVIDE A TEMPORARY TRASH ENCLOSURE ON SITE DURING ALL CONSTRUCTION ACTIVITIES TO CONTAIN DEBRIS AND PREVENT AIRBORNE LITTERING OFF SITE.
6. A WATER TRUCK SHALL BE USED ON SITE TO WET DOWN ALL EARTHWORK AND TO CONTROL AIRBORNE PARTICLES.
7. UNLESS SHOWN OTHERWISE ON THESE PLANS, ALL CONSTRUCTION SHALL CONFORM TO THE MARIICOPA ASSOCIATION OF GOVERNMENTS UNIFORM SPECIFICATIONS AND DETAILS FOR PUBLIC WORKS CONSTRUCTION" LATEST EDITIONS AS ADMINISTERED BY THE CITY OF PAGE.
8. EXISTING UNDERGROUND UTILITIES AND IMPROVEMENTS ARE SHOWN IN THEIR APPROXIMATE LOCATIONS BASED UPON RECORD INFORMATION AVAILABLE AT THE TIME OF PREPARATION OF PLANS. LOCATIONS MAY NOT HAVE BEEN VERIFIED IN THE FIELD AND NO GUARANTEE IS MADE AS TO ACCURACY OR COMPLETENESS OF THE INFORMATION SHOWN. IT SHALL BE THE RESPONSIBILITY OF THE CONTRACTOR TO DETERMINE THE EXACT LOCATION (HORIZONTAL AND VERTICAL) OF THOSE UTILITIES SHOWN ON THESE PLANS OR INDICATED IN THE FIELD BY LOCATING SERVICES. ANY ADDITIONAL COSTS INCURRED AS A RESULT OF CONTRACTORS FAILURE TO VERIFY LOCATIONS OF EXISTING UTILITIES PRIOR TO BEGINNING OF CONSTRUCTION IN THEIR VICINITY SHALL BE BORNE BY THE CONTRACTOR AND INCLUDED IN THE CONSTRUCTION CONTRACT.
9. ALL EXCAVATIONS AND GRADINGS SHALL BE IN ACCORDANCE WITH THE REQUIREMENTS OF THE CITY OF PAGE, AND APPENDIX "J" OF THE "INTERNATIONAL BUILDING CODE", LATEST EDITION.
10. OWNER/CONTRACTOR SHALL INSTALL AN INFORMATIONAL SIGN ON SITE BEFORE CONSTRUCTION BEGINS. THIS SIGN WILL HAVE A MINIMUM SIZE, PLACEMENT LOCATION AND CONTENT INFORMATION WITH THE COMPANY NAME, PHONE CONTACT & GRADING PERMIT NUMBER.
11. OWNER/CONTRACTOR SHALL SUBMIT A DUST CONTROL PLAN WITH DETAILS ON EQUIPMENT, SCHEDULING AND REPORTING OF DUST CONTROL ACTIVITIES.
12. A MANDATORY PRE-CONSTRUCTION MEETING WILL BE REQUIRED ON ALL PROJECTS PRIOR TO ANY GRUBBING, GRADING, OR CONSTRUCTION ACTIVITIES. THE PERMIT HOLDER SHALL BE REQUIRED TO NOTIFY ALL DEVELOPMENT SERVICES INSPECTORS.
13. CONTRACTOR SHALL PROVIDE SUBMITTALS FOR UTILITY MATERIALS FOR CITY APPROVAL PRIOR TO ORDERING.
14. ALL OBJECTS SHALL BE KEPT OUT OF THE SIGHT DISTANCE CORRIDORS THAT MAY OBSTRUCT THE DRIVER'S VIEW.
15. PERMISSION WILL NEED TO BE OBTAINED FROM ADJOINING PROPERTY OWNERS BEFORE GRADING ACROSS PROPERTY LINES.

UTILITY NOTES:

1. LOCATION OF ALL UNDERGROUND UTILITIES SHOWN ARE APPROXIMATE LOCATIONS. CONTRACTOR IS RESPONSIBLE FOR VERIFYING CONNECTION POINTS TO EXISTING UTILITIES. CONTRACTOR IS RESPONSIBLE FOR ANY DAMAGE CAUSED TO EXISTING UTILITIES AND UTILITY STRUCTURES THAT ARE TO REMAIN.
2. ALL UTILITIES SHALL BE BLUE STAKED PRIOR TO START OF CONSTRUCTION.
3. ALL WORK SHALL BE FULLY INSPECTED BY THE CITY AND/OR UTILITY PROVIDER PRIOR TO COVERING. ANY WORK WHICH HAS NOT BEEN INSPECTED AND APPROVED BEFORE IT IS BURIED SHALL BE EXPOSED AT THE CONTRACTORS EXPENSE.
4. BEST MANAGEMENT PRACTICES SHALL BE EMPLOYED BY THE CONTRACTOR THROUGHOUT CONSTRUCTION.
5. ALL WATER AND SEWER LINES SHALL HAVE A MINIMUM DEPTH OF 36" TO THE TOP OF PIPE FROM THE FINISH GRADE SURFACE.
6. ALL WATER AND SEWER LINES SHALL HAVE A MINIMUM OF 10 FEET HORIZONTAL SEPARATION, MEASURED FROM OUTSIDE OF PIPE. A MINIMUM OF 2 FEET VERTICAL SEPARATION MUST BE MAINTAINED BETWEEN TOP OF SEWER AND BOTTOM OF WATER WHEN THE WATER LINE MUST CROSS THE SEWER LINE.
7. ALL WATER LINES SHALL BE CONSTRUCTED OF 6-400 PVC PIPE.
8. IT IS THE RESPONSIBILITY OF THE CONTRACTOR TO ENSURE ALL CONSTRUCTION AND TESTING OF SEWER AND WATER LINES SHALL BE IN ACCORDANCE WITH MAG AND ADEG STANDARDS.
9. WATER METERS SHALL BE INSTALLED ACCORDING TO CITY OF PAGE STANDARDS.
10. ALL ELECTRICAL CONDUIT SHALL BE PROVIDED AND INSTALLED BY OWNER (TRENCHING, BACKFILL AND COMPACTION).
11. ALL CONDUIT SHALL BE SCHEDULE 40 PVC. ALL SKEEPS SHALL BE 3' RADIUS LONG SKEEPS.
12. TRANSFORMER VAULTS AND TRANSFORMERS SHALL BE PROVIDED AND INSTALLED BY PAGE UTILITY ENTERPRISES AT COST TO CUSTOMER.
13. CONTRACTOR TO CONTACT POWER COMPANY FOR INSPECTIONS 24 HOURS IN ADVANCE.
14. CONTRACTOR TO CONTACT POWER COMPANY PRIOR TO CONSTRUCTION.
15. CONTRACTOR TO CONDUCT AIR TEST ON SEWER PRIOR TO COMPLETION.
16. CONTRACTOR TO CONDUCT BACTERIAL TEST ON WATERLINE PRIOR TO COMPLETION.
17. CONTRACTOR SHALL POTHOLE EXISTING UTILITIES AT THE REQUEST OF THE UTILITY COMPANY TO VERIFY THE DEPTH OF A LINE BELOW FINISH GRADE.
18. CONTRACTOR SHALL PROVIDE PAGE UTILITY ENTERPRISES A SUBMITTAL SHEET OF MATERIALS FOR APPROVAL PRIOR TO ORDERING ANY MATERIALS.
19. THE UTILITY COMPANY WILL PERFORM THE TAP INTO THE MAIN FOR THE SERVICE LINE BUT THE CONTRACTOR WILL EXPOSE THE MAIN AND INSTALL ALL MATERIAL.

PAVING NOTES:

- A. EXACT POINT OF MATCHING TERMINATION AND OVERLAY, IF NECESSARY, SHALL BE DETERMINED IN THE FIELD BY THE CITY ENGINEER OR HIS AUTHORIZED REPRESENTATIVE. WHEN A LONGITUDINAL JOINT ASSOCIATED WITH A TRENCH PATH, PAVEMENT MATCH UP OR OTHER OCCURS ON A STREET THAT INCLUDES A BIKE LANE, THE JOINT SHALL BE LOCATED OUTSIDE THE BIKE LANE.
- B. NO JOB WILL BE CONSIDERED COMPLETE UNTIL:
 1. ALL CURBS, PAVEMENTS, SIDEWALKS, CATCH BASINS, STORM DRAINS, AND MANHOLES HAVE BEEN CLEANED OF ALL DIRT AND DEBRIS.
 2. SURVEY MONUMENTS ARE INSTALLED AND STAMPED AND;
 3. ALL FRAMES, COVERS, AND VALVE BOXES ARE ADJUSTED TO GRADE.
- C. NO PAVING CONSTRUCTION SHALL BE STARTED UNTIL ALL UTILITY LINES ARE COMPLETED AND APPROVED UNDER PROPOSED PAVED AREAS.
- D. BASE COURSE WILL NOT BE PLACED UNTIL SUBGRADE HAS BEEN APPROVED BY THE CITY ENGINEER OR HIS AUTHORIZED REPRESENTATIVE.
- E. THE LOCATION OF ALL WATER VALVES, FIRE HYDRANTS, AND MANHOLE MUST AT ALL TIMES DURING CONSTRUCTION BE REFERENCED AND MADE ACCESSIBLE TO THE CITY.
- F. UTILITY FACILITIES IN CONFLICT WITH THIS WORK WILL BE RELOCATED BY THE PERMITTEE OR THE UTILITY OWNER. THE ACTIVITY SHALL BE COORDINATED WITH THE OWNER OF THE UTILITY TO PREVENT ANY UNNECESSARY INTERRUPTION OF SERVICE TO EXISTING CUSTOMERS.
- G. EXISTING STREET NAME SIGNS, TRAFFIC SIGNS AND DEVICES ASSOCIATED WITH THE PROJECT SHALL BE MAINTAINED DURING CONSTRUCTION AND RELOCATED BY THE CONTRACTOR AS SHOWN ON THE APPROVED PLANS.
- H. ANY CHANGES OR ADDITIONS TO PAVEMENT MARKINGS CAUSED BY PAVEMENT OVERLAY, CHIP SEAL, OR INSTALLATION OF UNDERGROUND FACILITIES SHALL BE SHOWN ON THE APPROVED PLANS.
- I. ON PROJECTS WHERE THE CONTRACTOR CAUSES EXCESSIVE DAMAGE TO AN EXISTING PAVED STREET OR THERE ARE MULTIPLE STREET CUTS (MAXIMUM OF FOUR (4) IN FIVE HUNDRED (500) FEET) AN ASPHALT OVERLAY SHALL BE REQUIRED.
- J. A PRIME COAT IS NOT REQUIRED UNLESS SO SPECIFIED IN THE SOILS AND PAVEMENT REPORT AND/OR SHOWN ON THE PLANS.
- K. ALL CURB AND GUTTER, SIDEWALK, DRIVEWAYS, AND SIDEWALK RAMPS SHALL BE CONSTRUCTED ON A MINIMUM THREE (3) INCHES OF AGGREGATE BASE COURSE (ABC). THE ABC SHALL BE CONSTRUCTED PER MAG SECTION 310, AND SHALL BE COMPACTED TO NINETY-FIVE PERCENT (95%) RELATIVE DENSITY. ALL PRECAST STRUCTURES SUCH AS MANHOLE BASES, CATCH BASINS, AND BOX CULVERTS SHALL BE CONSTRUCTED ON A MINIMUM OF THREE (3) INCHES OF ABC.
- L. PERMANENT PAVEMENT MARKINGS.
 1. LONGITUDINAL PAVEMENT MARKINGS SHALL BE INSTALLED IN ACCORDANCE WITH ADOT STANDARD SPECIFICATION 108.
 2. TRAVERSE PAVEMENT MARKINGS SUCH AS STOP BARS, CROSSWALKS, ARROWS, AND LEGENDS SHALL BE INSTALLED IN ACCORDANCE WITH ADOT STANDARD SPECIFICATION 108.
- M. TEMPORARY PAVEMENT MARKINGS.
 1. TEMPORARY PAVEMENT MARKINGS, WHEN APPROVED, SHALL BE INSTALLED IN ACCORDANCE WITH ADOT STANDARD SPECIFICATION 108.

NOTES:

1. THE USE OF TEMPORARY MARKINGS IS STRONGLY DISCOURAGED AND MAY ONLY BE USED WITH PRIOR APPROVAL.
2. WHEN IT IS USED, THE CONTRACTOR MUST BE AVAILABLE TO RE-STRIPE AS NEEDED UNTIL THE PERMANENT MARKINGS CAN BE INSTALLED.
3. WHEN IT IS IMPRACTICABLE FOR THE CONTRACTOR TO PROVIDE PERMANENT MARKINGS, THE CITY PUBLIC WORKS DEPARTMENT MAY INSTALL THE MARKING ON BEHALF OF THE CONTRACT PROVIDING THE FEE FOR THE WORK IS AGREED UPON AND PAID FOR IN ADVANCE.
- N. THE MAXIMUM THICKNESS OF A SINGLE LIFT OF PAVEMENT SHALL BE PER M.A.S. STANDARD SPECIFICATIONS SECTION 321.

TRAFFIC CONTROL NOTES:

CONTRACTOR TO COORDINATE WITH THE CITY OF PAGE AND MAINTAIN AT LEAST ONE LANE OF TRAFFIC OPEN AT ALL TIMES DURING CONSTRUCTION.

EARTHWORK VOLUMES:

150	(C) CU. YD. CUT
299	(F) CU. YD. FILL
144	(F) CU. YD. NET

THE EARTHWORK CUT AND FILL VOLUMES SHOWN ON THIS PLAN ARE BASED ON THE VOLUME DIFFERENCES BETWEEN TWO DIGITAL TERRAIN MODELS (DTMs), OR SURFACES; THE EXISTING GROUND SURFACE AND THE PROPOSED FINISHED GRADE SURFACE. THE CONTRACTOR IS TO CALCULATE THE PROPOSED FINISHED SUB-GRADE SURFACE BY SUBTRACTING THE VOLUME OF THE PROPOSED IMPROVEMENTS; ASPHALT, CURB AND GUTTER, SIDEWALK, WATERWAYS, HANDICAP RAMPS, AND BASE COURSE FROM VOLUME OF THE PROPOSED FINISHED GROUND SURFACE. THIS COMPARISON IS PRESENTED FOR REFERENCE ONLY AS THE FIRST STEP IN THE PROCESS OF PERFORMING THOROUGH EARTHWORK CALCULATIONS, AND DOES NOT REFLECT OR REPRESENT A FINAL ESTIMATE OF ACTUAL EARTH TO BE MOVED. UPON REVIEW OF THE GEOTECHNICAL REPORT, THE CONTRACTOR RESPONSIBLE FOR EXCAVATION SHALL ACCOUNT FOR OVER-EXCAVATION, SCARIFYING, AND ADJUSTMENT FOR ALL IMPROVEMENTS NOT ACCOUNTED FOR IN THE FINISHED SUB-GRADE SURFACE, INCLUDING LANDSCAPING, BULKING AND/OR SHRINKAGE OF MATERIAL, IMPORT OF BEDDING MATERIAL AND OTHER MATERIALS, EXCAVATION AND COMPACTION OF UTILITY TRENCHES, AND OTHER FACTORS TO MAKE A FINAL DETERMINATION OF THE TOTAL EARTHWORK REQUIRED FOR THE PROJECT. IN SOME CASES, ADDITIONAL CONSULTATIONS WITH THE GEOTECHNICAL ENGINEER AND CIVIL ENGINEER MAY BE REQUIRED.

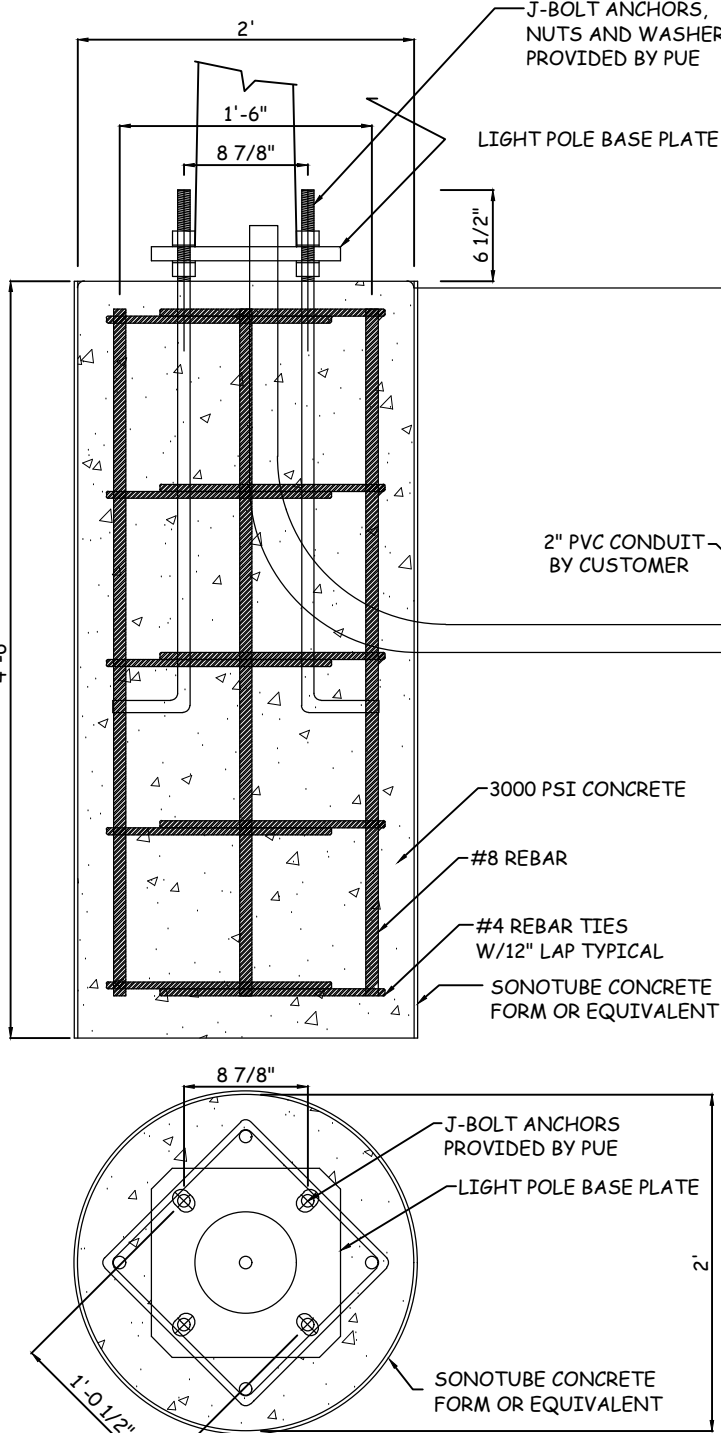

4' 6" FLUSH FOUNDATION DETAIL
STREET LIGHT BASE TYPICAL CITY OF PAGE

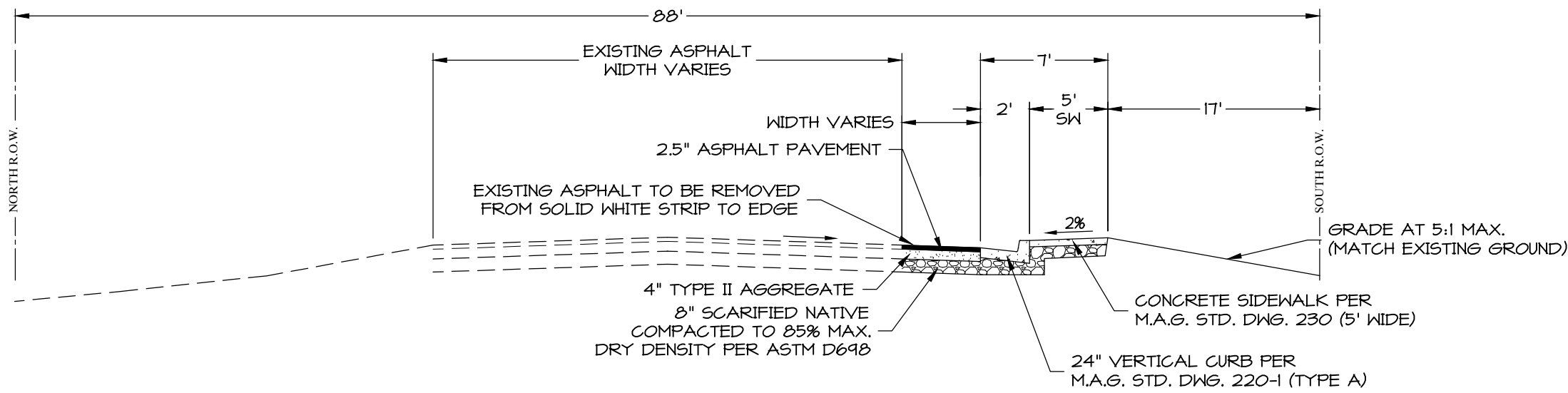

A 88' R.O.W.
SCALE: N.T.S.

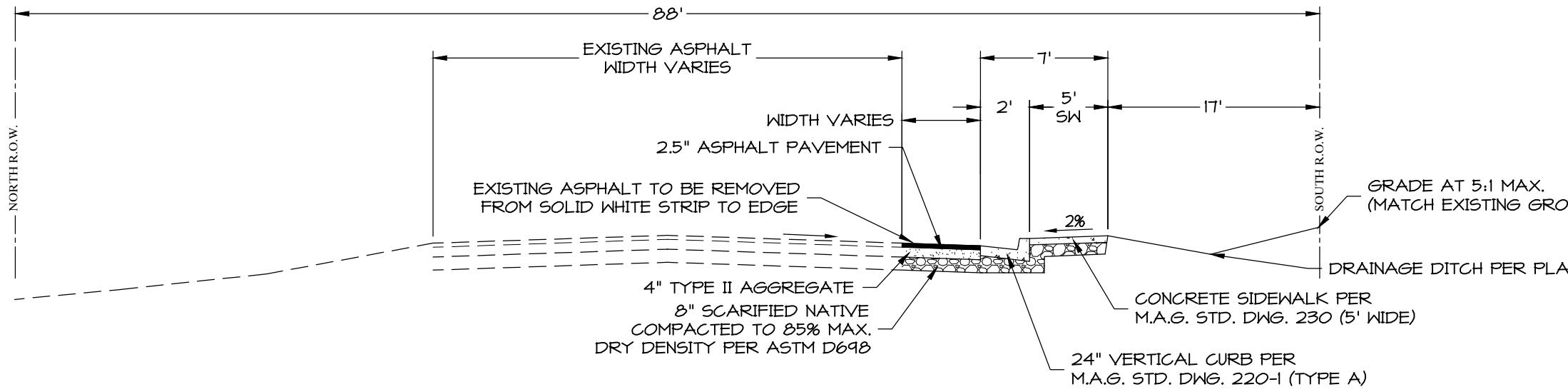

B 88' R.O.W.
SCALE: N.T.S.

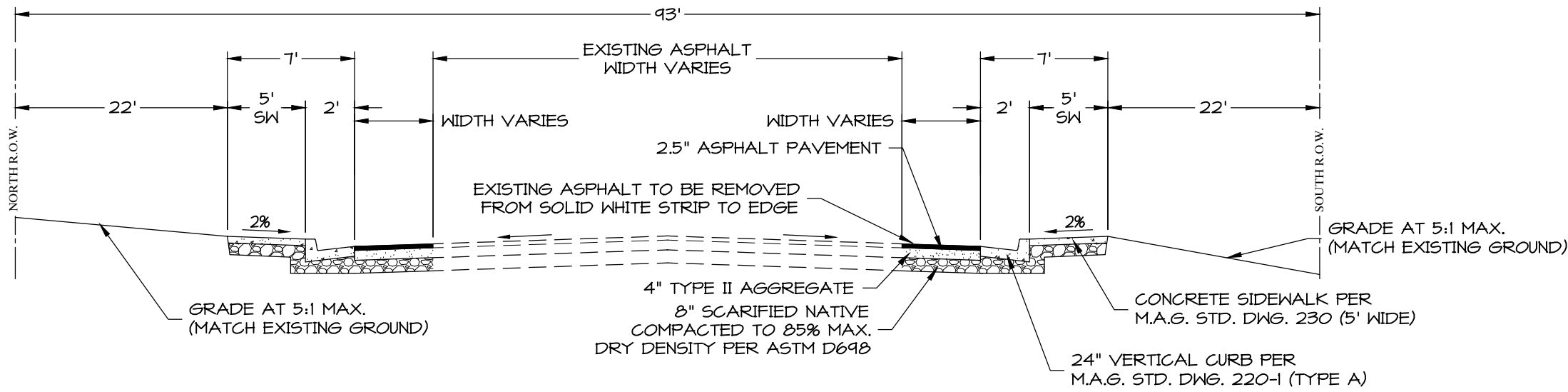

C 93' R.O.W.
SCALE: N.T.S.

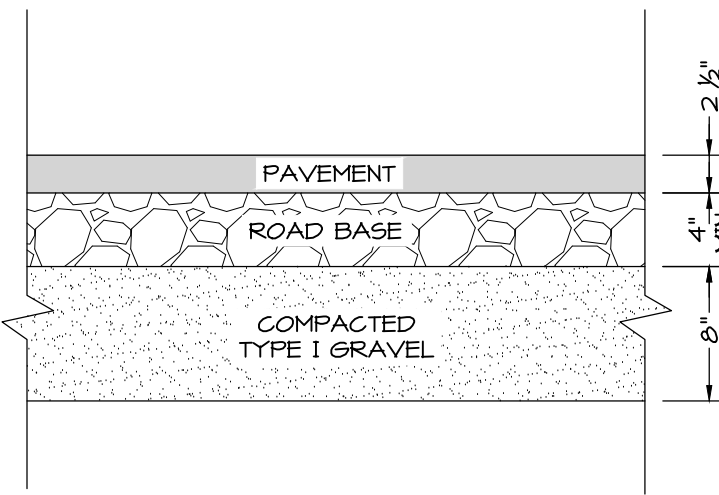

IT IS THE CONTRACTORS RESPONSIBILITY TO BECOME FAMILIAR WITH THE GEOTECHNICAL REPORT PRIOR TO STARTING ANY CONSTRUCTION.

VERIFY WITH GEOTECHNICAL REPORT

D PAVEMENT SECTION
SCALE: N.T.S.

DATE:	02/19/2025
JOB NO:	12448-24-006
DESIGNED BY:	FMD
CHECKED BY:	MSR
DWG:	CONST DOCS
DATE:	
REVISIONS:	

ROSENBERG
A S S O C I A T E S
CIVIL ENGINEERS • LAND SURVEYORS

352 East Riverside Drive, Suite A-2
St. George, Utah 84790
Ph (435) 673-8899 Fx (435) 673-8397
www.racivil.com

GENERAL NOTES AND DETAILS
FOR
HAUL ROAD SOUTH IMPROVEMENTS
PAGE, ARIZONA

Professional Engineer
49894
MICHAEL S. ROBINSON
02/19/25
ATLANTA, U.S.A.
EXP: 04/30/2027

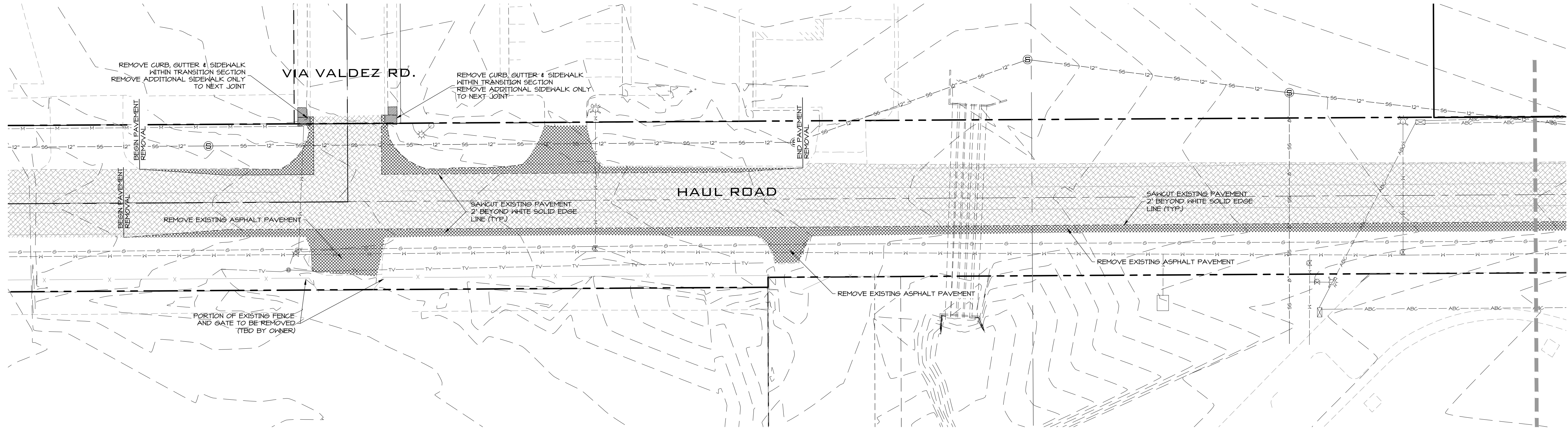

DEMOLITION PLAN

LEGEND			
	RIGHT-OF-WAY		EXISTING UNDERGROUND POWER
	RIGHT-OF-WAY/ROAD EASEMENT		EXISTING SEWER MAIN
	EXISTING CURB & GUTTER		EXISTING GAS LINE
	PROPOSED CURB & GUTTER		PROPOSED SECONDARY POWER
	PROPOSED ASPHALT PAVEMENT		PROPOSED STREETLIGHT
	EXISTING ASPHALT PAVEMENT		EXISTING STREET LIGHT
	EXISTING ASPHALT PAVEMENT TO BE REMOVED		EXISTING WATER METER
	SIGN AS INDICATED ON PLANS		EXISTING WATER VALVE
	EXISTING WATER MAIN		EXISTING FIRE HYDRANT
			EXISTING SEWER MANHOLE

CONSTRUCTION NOTES

- 24" VERTICAL CURB AND GUTTER PER MAG. STD. DWG. #220-1 (TYPE A)
- CONCRETE SIDEWALK PER MAG. STD. DWG. #230 (5' WIDE)
- ASPHALT PAVEMENT PER DETAIL D/C2.0
- A.D.A. CURB RAMP PER MAG. STD. DWG. #236-5
- MATCH EXISTING CURB ALIGNMENT AND ELEVATION
- INSTALL CROSSWALK MARKINGS PER C.O.F. STANDARD DETAIL 16-06-10 (PAVEMENT MARKINGS SHALL BE METHYL METHACRYLATE).
- INSTALL 18" WHITE STOP BAR PER C.O.F. STANDARD DETAIL 16-06-10 PAVEMENT MARKINGS
- INSTALL 2'-6" WIDE SCUPPER PER M.A.S. STD. DWG. #203
- INSTALL VALLEY GUTTER PER M.A.S. STD. DWG. #240
- INSTALL 30" STOP SIGN PER MUTCD STANDARDS
- INSTALL PEDESTRIAN CROSSING WARNING SIGN (W-2) PER MUTCD.

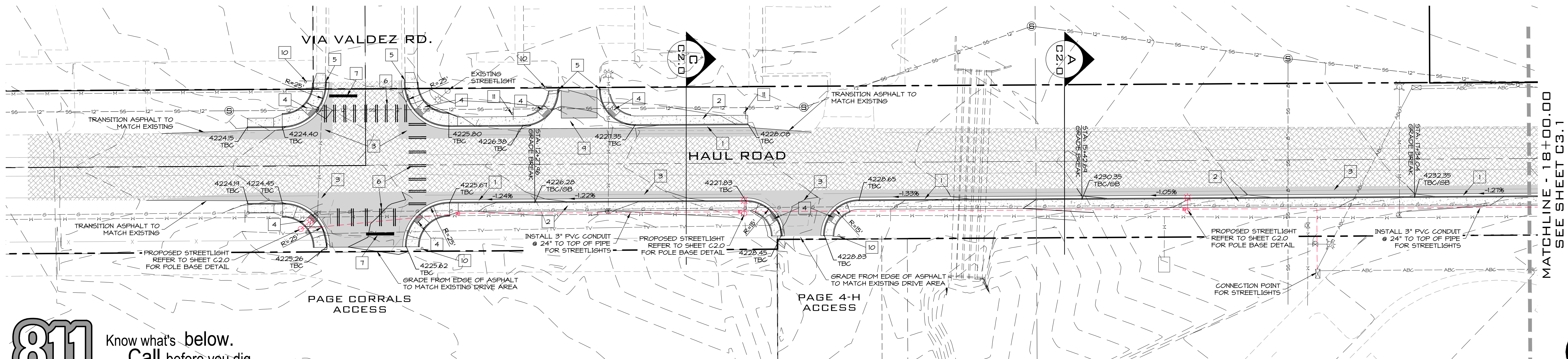

SITE & GRADING PLAN

CONTRACTOR TO FIELD VERIFY ALL EXISTING UTILITIES (HORIZ & VERT) PRIOR TO START OF CONSTRUCTION



Know what's below.
Call before you dig.

NOTICE: EXISTING UTILITIES ARE SHOWN ON PLANS FOR THE CONVENIENCE OF THE CONTRACTOR ONLY. THE CONTRACTOR IS RESPONSIBLE FOR THE LOCATION AND PROTECTION OF ALL UTILITIES. THE ENGINEER BEARS NO RESPONSIBILITY FOR UTILITIES NOT SHOWN OR SHOWN INCORRECTLY.

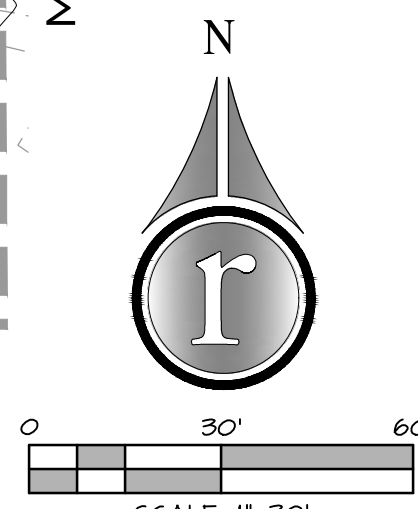

DATE:	02/19/2025
JOB NO.:	12448-24-006
DESIGNED BY:	FMD
CHECKED BY:	MSR
DWG:	CONST DOCS
DATE:	
REVISIONS:	

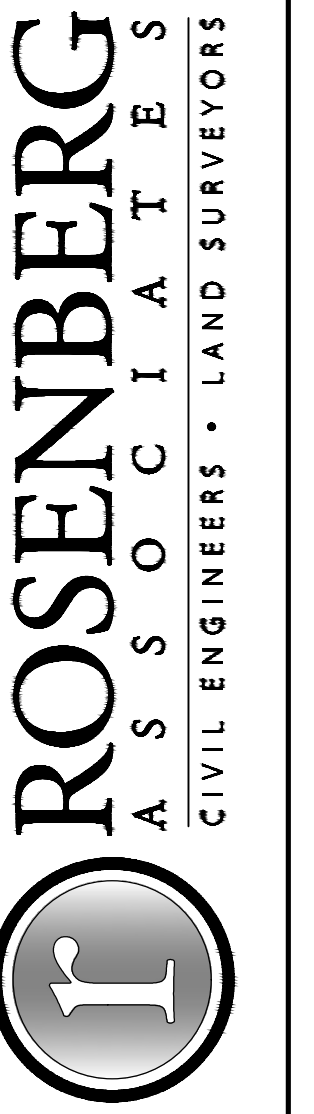

352 East Riverside Drive, Suite A-2
St. George, Utah 84790
Ph (435) 673-8890, Fx (435) 673-8397
www.racivil.com

SITE AND GRADING PLAN
FOR
HAUL ROAD SOUTH IMPROVEMENTS
PAGE, ARIZONA

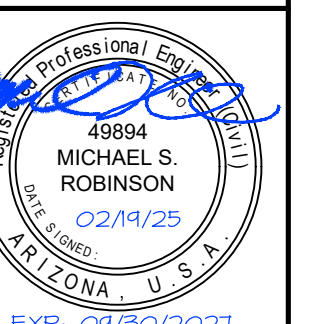

SHEET
C3.0
3 OF 5 SHEETS

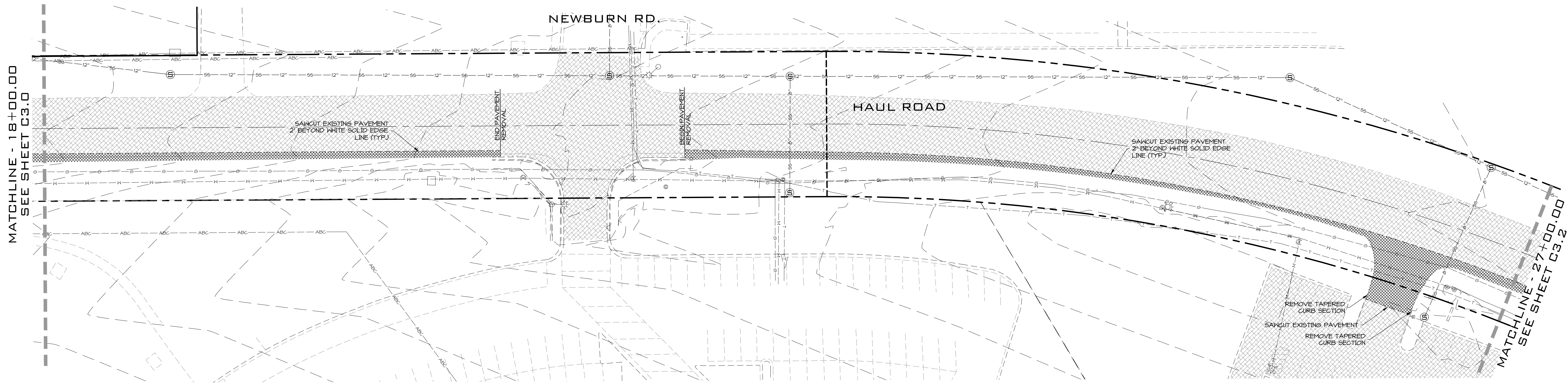

DEMOLITION PLAN

LEGEND			
	RIGHT-OF-WAY		EXISTING UNDERGROUND POWER
	RIGHT-OF-WAY/ROAD EASEMENT		EXISTING SEWER MAIN
	EXISTING CURB & GUTTER		EXISTING GAS LINE
	PROPOSED CURB & GUTTER		PROPOSED SECONDARY POWER
	PROPOSED ASPHALT PAVEMENT		PROPOSED STREETLIGHT
	EXISTING ASPHALT PAVEMENT		EXISTING STREET LIGHT
	EXISTING ASPHALT PAVEMENT TO BE REMOVED		EXISTING WATER METER
	SIGN AS INDICATED ON PLANS		EXISTING WATER VALVE
	EXISTING WATER MAIN		EXISTING FIRE HYDRANT
			EXISTING SEWER MANHOLE

CONSTRUCTION NOTES

- 24" VERTICAL CURB AND GUTTER PER MAG. STD. DWG. #220-1 (TYPE A)
- CONCRETE SIDEWALK PER MAG. STD. DWG. #230 (5' WIDE)
- ASPHALT PAVEMENT PER DETAIL D/C2.0
- A.D.A. CURB RAMP PER MAG. STD. DWG. #236-5
- MATCH EXISTING CURB ALIGNMENT AND ELEVATION
- INSTALL CROSSWALK MARKINGS PER C.O.F. STANDARD DETAIL 16-06-10 (PAVEMENT MARKINGS SHALL BE METHYL METHACRYLATE).
- INSTALL 18" WHITE STOP BAR PER C.O.F. STANDARD DETAIL 16-06-10 PAVEMENT MARKINGS
- INSTALL 2'-6" WIDE SCUPPER PER M.A.S. STD. DWG. #203
- INSTALL VALLEY GUTTER PER M.A.S. STD. DWG. #240
- INSTALL 30" STOP SIGN PER MUTCD STANDARDS
- INSTALL PEDESTRIAN CROSSING WARNING SIGN (W-2) PER MUTCD.

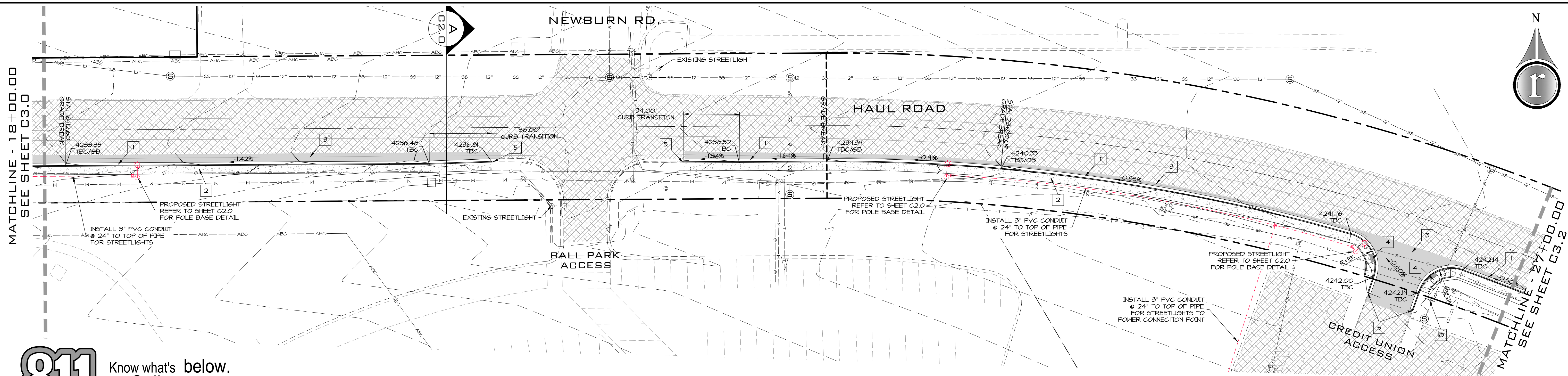

SITE & GRADING PLAN



Know what's below.
Call before you dig.

NOTICE: EXISTING UTILITIES ARE SHOWN ON PLANS FOR THE CONVENIENCE OF THE CONTRACTOR ONLY. THE CONTRACTOR IS RESPONSIBLE FOR THE LOCATION AND PROTECTION OF ALL UTILITIES. THE ENGINEER BEARS NO RESPONSIBILITY FOR UTILITIES NOT SHOWN OR SHOWN INCORRECTLY.

CONTRACTOR TO FIELD VERIFY ALL EXISTING UTILITIES (HORIZ & VERT) PRIOR TO START OF CONSTRUCTION

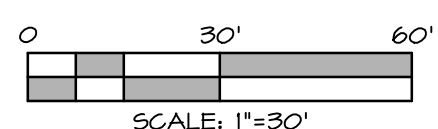

DATE:	02/19/2025
JOB NO.:	12448-24-006
DESIGNED BY:	FMD
CHECKED BY:	MSR
DWG:	CONST DOCS
DATE:	
REVISIONS:	



352 East Riverside Drive, Suite A-2
St. George, Utah 84790
Ph (435) 673-8896 Fx (435) 673-8397
www.racivil.com

SITE AND GRADING PLAN
FOR
HAUL ROAD SOUTH IMPROVEMENTS
PAGE, ARIZONA

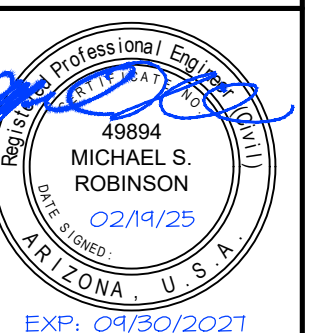

SHEET

C3.1

4 OF 5 SHEETS

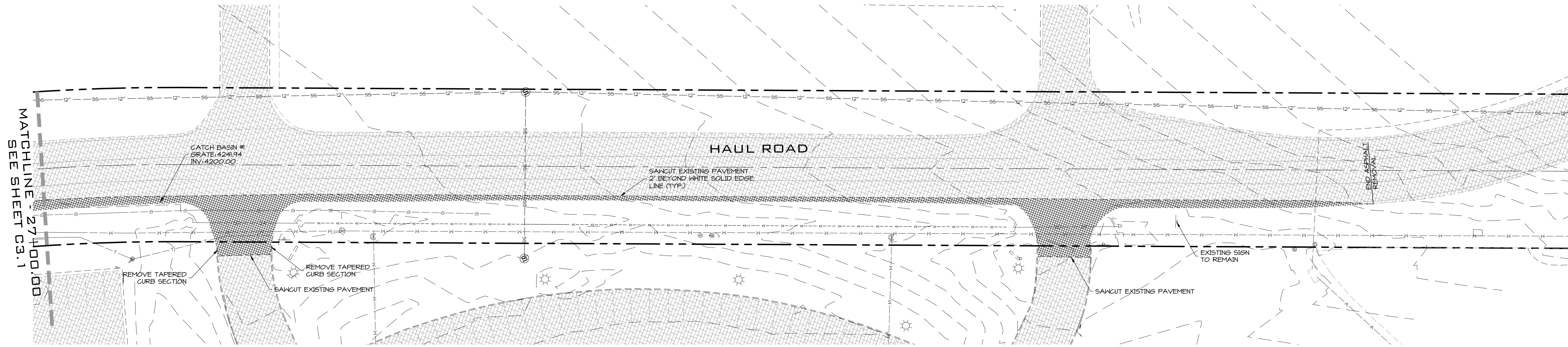

DEMOLITION PLAN

LEGEND			
	RIGHT-OF-WAY		EXISTING UNDERGROUND POWER
	RIGHT-OF-WAY/ROAD EASEMENT		EXISTING SEWER MAIN
	EXISTING CURB & GUTTER		EXISTING GAS LINE
	PROPOSED CURB & GUTTER		PROPOSED SECONDARY POWER
	PROPOSED ASPHALT PAVEMENT		PROPOSED STREETLIGHT
	EXISTING ASPHALT PAVEMENT		EXISTING STREET LIGHT
	EXISTING ASPHALT PAVEMENT TO BE REMOVED		EXISTING WATER METER
	SIGN AS INDICATED ON PLANS		EXISTING WATER VALVE
	EXISTING WATER MAIN		EXISTING FIRE HYDRANT
			EXISTING SEWER MANHOLE

- CONSTRUCTION NOTES
- 24" VERTICAL CURB AND GUTTER PER MAG. STD. DWG. #220-1 (TYPE A)
 - CONCRETE SIDEWALK PER MAG. STD. DWG. #230 (5' WIDE)
 - ASPHALT PAVEMENT PER DETAIL D/C2.0
 - A.D.A. CURB RAMP PER MAG. STD. DWG. #236-5
 - MATCH EXISTING CURB ALIGNMENT AND ELEVATION
 - INSTALL CROSSWALK MARKINGS PER C.O.P. STANDARD DETAIL 16-06-10 (PAVEMENT MARKINGS SHALL BE METHYL METHACRYLATE).
 - INSTALL 18" WHITE STOP BAR PER C.O.P. STANDARD DETAIL 16-06-10 PAVEMENT MARKINGS
 - INSTALL 2'-6" WIDE SCUPPER PER M.A.S. STD. DWG. #203
 - INSTALL VALLEY GUTTER PER M.A.S. STD. DWG. #240
 - INSTALL 30" STOP SIGN PER MUTCD STANDARDS
 - INSTALL PEDESTRIAN CROSSING WARNING SIGN (W-2) PER MUTCD.

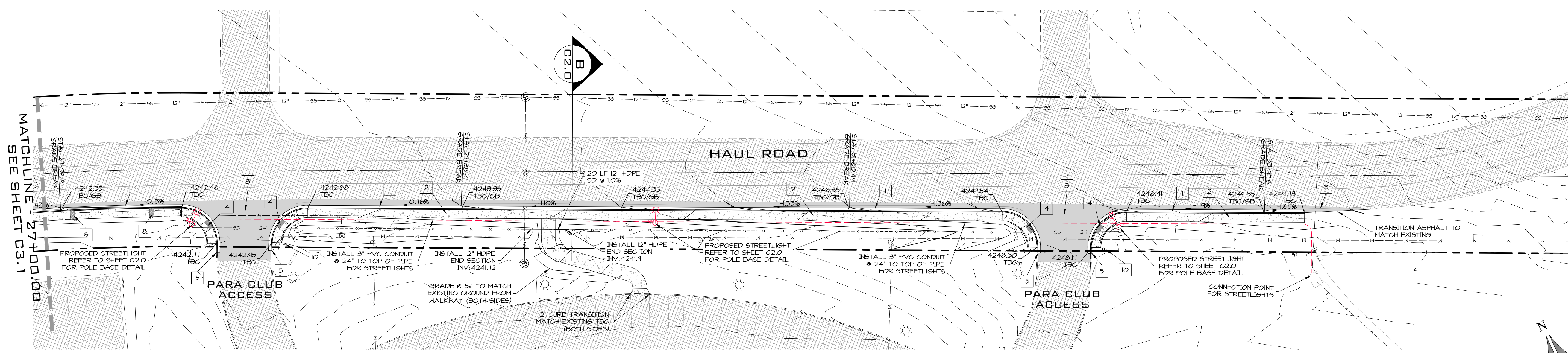

SITE & GRADING PLAN

811 Know what's below.
Call before you dig.

NOTICE:
EXISTING UTILITIES ARE SHOWN ON PLANS FOR THE CONVENIENCE OF THE CONTRACTOR ONLY. THE CONTRACTOR IS RESPONSIBLE FOR THE LOCATION AND PROTECTION OF ALL UTILITIES. THE ENGINEER BEARS NO RESPONSIBILITY FOR UTILITIES NOT SHOWN OR SHOWN INCORRECTLY.

CONTRACTOR TO FIELD VERIFY ALL EXISTING UTILITIES (HORIZ & VERT) PRIOR TO START OF CONSTRUCTION

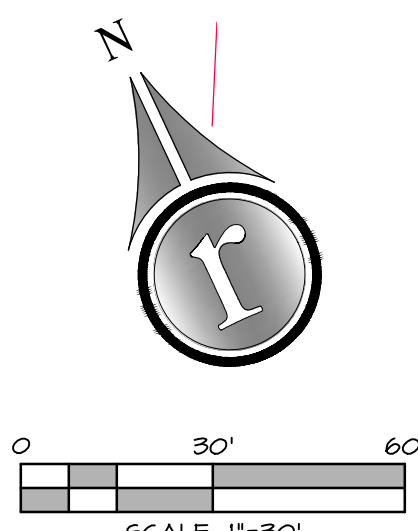

DATE:	02/19/2025
JOB NO.:	12448-24-006
DESIGNED BY:	FMD
CHECKED BY:	MSR
DWG.:	CONST DOCS
DATE:	
REVISIONS:	

ROSENBERG
A S S O C I A T E S
CIVIL ENGINEERS • LAND SURVEYORS

352 East Riverside Drive, Suite A-2
St. George, Utah 84790
Ph (435) 673-8896, Fx (435) 673-8397
www.racivil.com

SITE AND GRADING PLAN
FOR
HAUL ROAD SOUTH IMPROVEMENTS
PAGE, ARIZONA

Professional Engineer
49894
MICHAEL S. ROBINSON
02/19/25
EXP. 04/30/2027

SHEET
C3.2
5 OF 5 SHEETS